



20 Feet

This map is dedicated to the memory of Charlotte Tenney, M.A., Herbalist, San Diego Herb Guild Co-Founder, Trees for Health Arboretum Balboa Park, San Diego, California, USA

170 species were sighted and identified in the August 2015 survey as noted.

The arboretum is always growing and changing, so your own experience will be different and unique!

May this map enhance your enjoyment of the garden, and help encourage your interest and support of further research in natural medicine.

Joseph Angel Ureño, J.D. Doctoral Candidate 2018 Naturopathic Medicine Bastyr University California

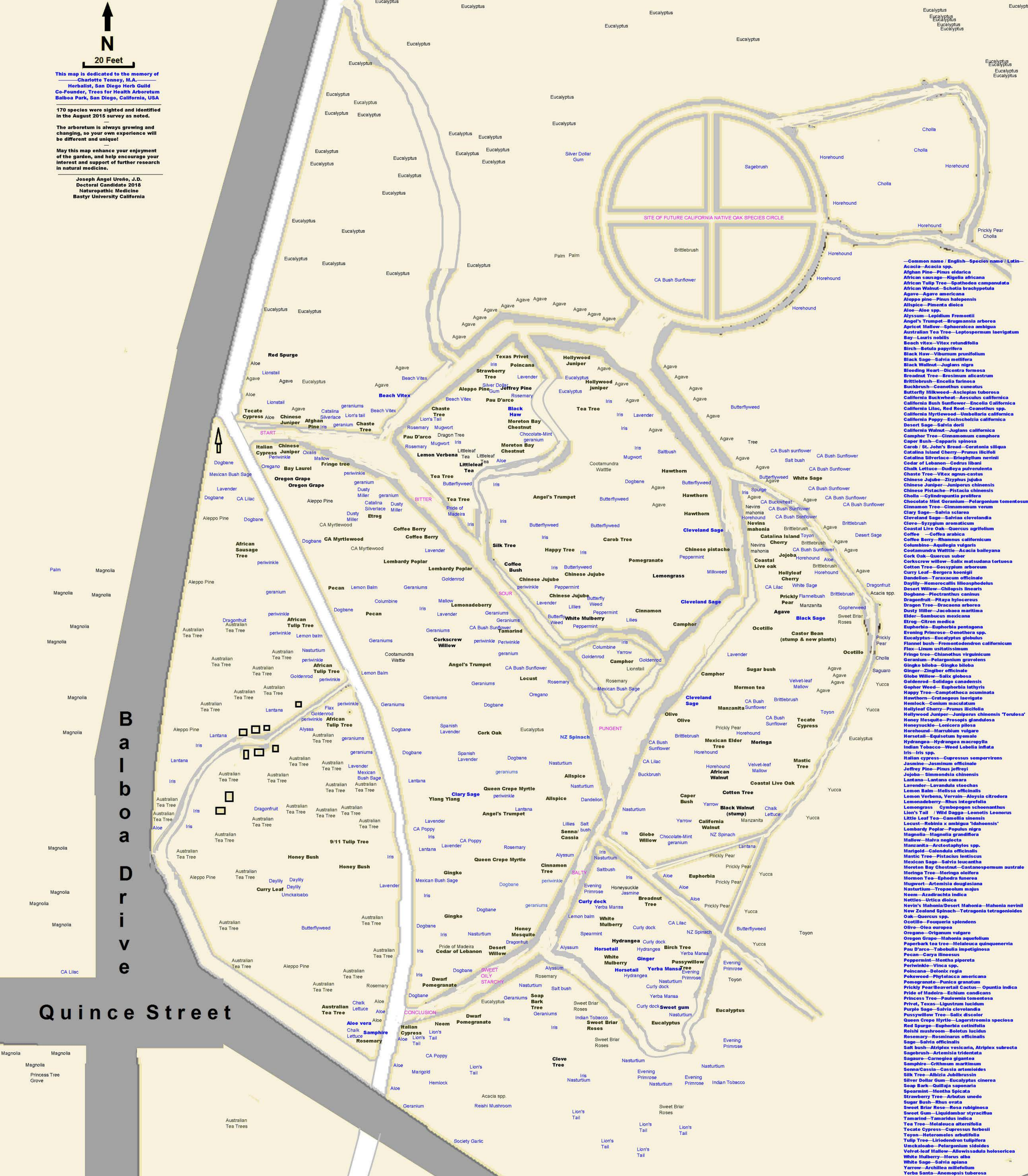

- Common name / English—Species name / Latin—
- Acacia—Acacia spp.
  - Alghian Pine—Pinus edulis
  - African sausage—Kigelia africana
  - African Tulip Tree—Spathodea campanulata
  - African Walnut—Schottia brachypetala
  - Agave—Agave americana
  - Allegro pine—Pinus halepensis
  - Allspice—Pimenta dioica
  - Aloe—Aloe spp.
  - Alyssum—Lepidium fremontii
  - Angel's Trumpet—Brugmansia arborea
  - Apricot Mallow—Sphaeralcea ambigua
  - Australian Tea Tree—Leptospermum laevigatum
  - Bay—Laurus nobilis
  - Beach Vitex—Vitex rotundifolia
  - Birch—Betula papyrifera
  - Black Haw—Viburnum prunifolium
  - Black Sage—Salvia mellifera
  - Black Walnut—Juglans nigra
  - Bleeding Heart—Dicentra formosa
  - Breadnut Tree—Brosimum alicastrum
  - Brittlebrush—Encelia farinosa
  - Buckbrush—Ceanothus cuneatus
  - Butterfly Milkweed—Asclepias tuberosa
  - California Buckwheat—Aesculus californica
  - California Bush Sunflower—Encelia californica
  - California Lilac, Red Root—Ceanothus spp.
  - California Myrtlewood—Umbellularia californica
  - California Poppy—Eschscholzia californica
  - Desert Sage—Salvia dorii
  - California Walnut—Juglans californica
  - Campher Tree—Cinnamomum camphora
  - Caper Bush—Capparis spinosa
  - Carob / St. John's Bread—Ceratonia siliqua
  - Catalina Island Gumtree—Prunus ilicifolia
  - Catalina Silverface—Eriophyllum nevilli
  - Cedar of Lebanon—Cedrus libani
  - Chalk Lettuce—Pudleya pulvinata
  - Cholla—Yucca elata
  - Chinese Jujube—Zizyphus jujuba
  - Chinese Juniper—Juniperus chinensis
  - Chinese Pistache—Pistacia chinensis
  - Cholla—Cylindropuntia californicum
  - Chocolate Mint Geranium—Pelargonium tomentosum
  - Cinnamon Tree—Cinnamomum verum
  - Clary Sage—Salvia sclarea
  - Cleveland Sage—Salvia clevelandia
  - Clove—Syzgium aromaticum
  - Coastal Live Oak—Quercus agrifolia
  - Coffee—Coffea arabica
  - Coffee Berry—Rhamnus californicum
  - Columbine—Aquilegia vulgaris
  - Cotnamundra Wattle—Acacia baileyana
  - Cork Oak—Quercus suber
  - Corkscrew Willow—Salix matsudana tortuosa
  - Cotton Tree—Gossypium arboreum
  - Curry Leaf—Bergera koenigii
  - Dandelion—Taraxacum officinale
  - Daylily—Hemerocallis filicespedulus
  - Desert Willow—Chilopsis linearis
  - Dogbane—Plectranthus caninus
  - Dragonfruit—Pitaya hybridus
  - Dragon Tree—Dracaena arborea
  - Dusty Miller—Jacobaea maritima
  - Elder—Sambucus mexicana
  - Etiop—Citron medica
  - Euphorbia—Euphorbia pentagona
  - Evening Primrose—Oenothera spp.
  - Eucalyptus—Eucalyptus globulus
  - Flax—Linum catharticum
  - Fringe tree—Chionochloa virginicum
  - Geranium—Pelargonium graveolens
  - Gingko biloba—Gingko biloba
  - Globe Willow—Salix globosa
  - Goldenrod—Solidago canadensis
  - Gopher Weed—Euphorbia lathyris
  - Hoppy Tree—Caesalpinia coriaria
  - Hawthorn—Crataegus laevigata
  - Hemlock—Weed Lobelia inflata
  - Ironwood—Lyonia floribunda
  - Italian cypress—Cupressus sempervirens
  - Jasmine—Jasminum officinale
  - Jeffrey Pine—Pinus jeffreyi
  - Jobba—Simmondsia chinensis
  - Lantana—Lantana camara
  - Lavender—Lavandula stoechas
  - Lemon Balm—Melissa officinalis
  - Lemon Verbena, Vervain—Aloysia citrodora
  - Lemonadeberry—Rhus integrifolia
  - Lemongrass—Cymbopogon schoenanthus
  - Lion's Tail / Wild Dagg—Leonotis Leonorus
  - Little Leaf Tea—Camellia sinensis
  - Locust—Robinia x ambigua 'Idahoensis'
  - Lombardy Poplar—Populus nigra
  - Magnolia—Magnolia grandiflora
  - Mallow—Malva neglecta
  - Manzanita—Arctostaphylos spp.
  - Martgold—Calendula officinalis
  - Mastic Tree—Pistacia lentiscus
  - Mexican Sage—Salvia leucantha
  - Moron Bay Chestnut—Castanospemum australe
  - Moringa Tree—Moringa oleifera
  - Mormon Tea—Ephedra funerea
  - Mugwort—Artemisia douglasiana
  - Nasturtium—Tropaeolum majus
  - Neem—Azadirachta indica
  - Nettles—Urtica dioica
  - Nevin's Mahonia/Desert Mahonia—Mahonia nevilli
  - New Zealand Spinach—Tetragonia tetragonioides
  - Oak—Quercus spp.
  - Ocotillo—Fouquieria splendens
  - Olive—Olea europaea
  - Oregano—Origanum vulgare
  - Oregon Grape—Mahonia aquifolium
  - Paperbark tea tree—Melaleuca quinquenervia
  - Pau D'arco—Tabebuia impetiginosa
  - Pecan—Carya illinoensis
  - Peppermint—Mentha piperata
  - Periwinkle—Vinca spp.
  - Poinciana—Delonix regia
  - Pokeweed—Phytolacca americana
  - Pomegranate—Punica granatum
  - Prickly Pear/Beavertail Cactus—Opuntia indica
  - Pride of Madeira—Echium candicans
  - Princess Tree—Paulownia tomentosa
  - Privet, Texas—Ligustrum lucidum
  - Purple Sage—Salvia clevelandia
  - Pussywillow Tree—Salix discolor
  - Queen Creeper Myrtle—Aucuba speciosa
  - Red Spurge—Euphorbia cotinifolia
  - Reishi mushroom—Boletus lucidus
  - Rosemary—Rosmarinus officinalis
  - Sage—Salvia officinalis
  - Salt bush—Atriplex vesicaria, Atriplex subrecta
  - Sagebrush—Artemisia tridentata
  - Saguaro—Carnegiea gigantea
  - Samphire—Crithmum maritimum
  - Senna/Cassia—Cassia artemioides
  - Silk Tree—Albizia julibrissin
  - Silver Dollar Gum—Eucalyptus cinerea
  - Soap Bark Tree—Quillaja saponaria
  - Spearmint—Mentha spicata
  - Strawberry Tree—Arbutus unedo
  - Sugar Bush—Rhus ovata
  - Sweet Briar Rose—Rosa rubiginosa
  - Sweet Gum—Liquidambar styraciflua
  - Tamarind—Tamarindus indica
  - Tea Tree—Melaleuca alternifolia
  - Tecate Cypress—Cupressus forbesii
  - Toyon—Heteromeles arbustifolia
  - Tulip Tree—Liriodendron tulipifera
  - Umckaloabo—Pelargonium sidoides
  - Velvet-leaf Mallow—Albivisadula holosericea
  - White Mulberry—Morus alba
  - White Sage—Salvia apiana
  - Yarrow—Archillea millefolium
  - Yerba Santa—Anemopsis tuberosa
  - Yerba Mansa—Aemopsis californica
  - Ylang Ylang—Cananga odorata
  - Yucca—Hesperoyucca whipplei

Balboa Drive

Quince Street

Magnolia Magnolia Princess Tree Grove

Australian Tea Trees

Society Garlic

Lion's Tail

Lion's Tail

Lion's Tail

Lion's Tail

Lion's Tail

Lion's Tail

Lion's Tail

Lion's Tail

Lion's Tail